

ROLAIR
 SCHEMATIC FOR
 PMP12K35

Production starting 10/18

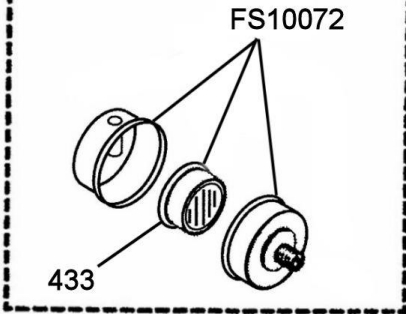

31002060CH
 37502450CH
 37403780CH

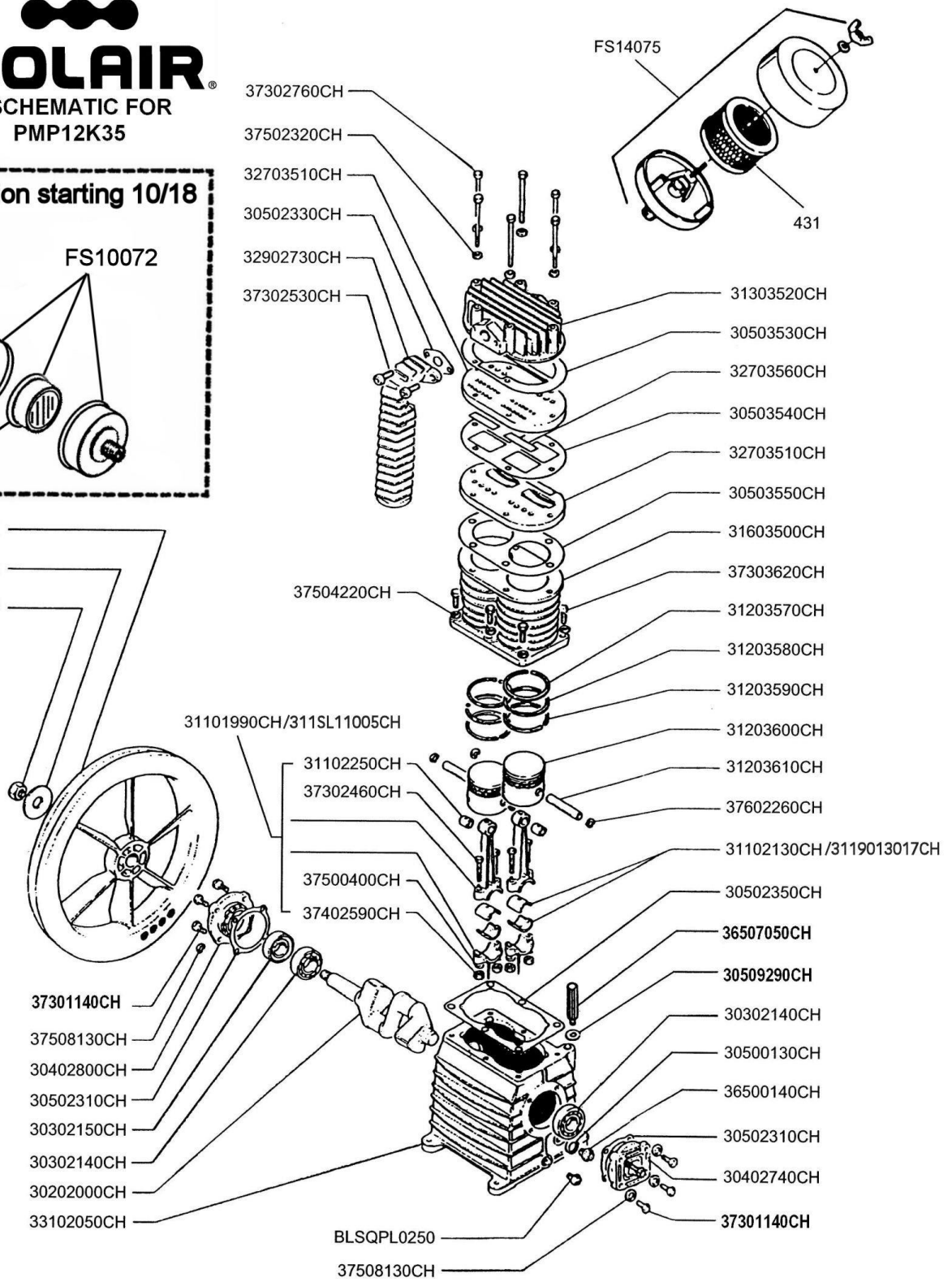

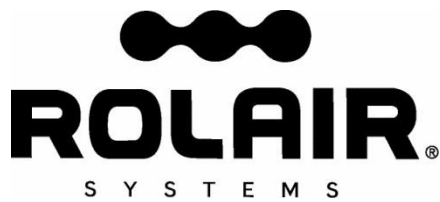

PARTS LIST FOR PMP12K35

Description	Part #	Qty.	Description	Part #	Qty.
Crankshaft	30202000CH	1	Crankcase	33102050CH	1
Bearing	30302140CH	2	Sight Gauge	36500140CH	1
Oil Seal	30302150CH	1	3/8" Breather/Oil Fill Plug	36500300CH	1
Bearing Carrier	30402740CH	1	Bolt	37301140CH	8
Bearing Carrier	30402800CH	1	Bolt	37302460CH	4
Gasket	30500130CH	1	Bolt	37302530CH	2
Gasket	3050016ACH	1	Bolt	37302760CH	6
Gasket	30502350CH	1	Bolt	37303620CH	6
Gasket	30502310CH	2	Nut	37402590CH	4
Gasket*	30502330CH	1	Nut	37403780CH	1
Gasket	30503530CH	1	Washer	37508130CH	8
Gasket	30503540CH	1	Washer	37500400CH	4
Gasket	30503550CH	1	Washer	37502320CH	6
Flywheel	31002060CH	1	Washer	37502450CH	1
Connecting Rod w/Upper Bushing	31101990CH	NLA	Washer	37504220CH	6
Connecting Rod w/Upper Bushing ***	311SL11005CH	2	Snap Ring	37602260CH	4
Bearing Shell (for 31101990CH connecting rod)	31102130CH	2	Filter Element for FS14075	431	1
Bearing Shell (for 311SL11005CH connecting rod)	3119013017CH	2	Filter Element for FS10072	433	1
Bushing **	31102250CH	2	Plug	BLSQPL0250	1
Ring	31203570CH	2	Intake Filter Assembly (before 10/18)	FS14075	1
Ring	31203580CH	2	Intake Filter Assembly (after 10/18)	FS10072	1
Ring	31203590CH	2	Ring Set	K35RINGS	1
Piston	31203600CH	2	Gasket Set	K35GASKETS	1
Piston Pin	31203610CH	2	Valve Plate Assembly (Reed Valves, Valve Plates & Upper 3 Gaskets)	3500VK35	1
Head	31303520CH	1	Valve Kit (Reed Valves & Upper 3 Gaskets)	VKK35	1
Cylinder	31603500CH	1			
Valve Plate	32703510CH	2			
Valve	32703560CH	8			
Aftercooler	32902730CH	1			

*Pumps produced after January 2005 use a 30502500CH O-Ring.

**Bushing is not machined to fit piston pin if ordered separate from connecting rod and must be bored to .005" over O.D. of piston pin after being pressed into place (For connecting rod with casting number of 31101990 only).

***Has casting number of SL11165. Must order 311SL11005CH1 connecting rod assembly when replacing 31101990CH rod. Bearing shells used in 31101990CH and 311SL11005CH connecting rods are not interchangeable.

